

Formulate® Backlit Ring Tower

RNG-TOW-BL

The Formulate® 10ft Backlit Ring Tower is a commanding structure that will help your message and brand stand out. This glowing structure stands just over 14ft tall and is about 10ft wide. The Ring Tower kit is made of aluminum tube frames, LED light curtains and printed fabric graphics. This display is ideal for use in interiors with high ceilings, tradeshow exhibits, stage sets and more!

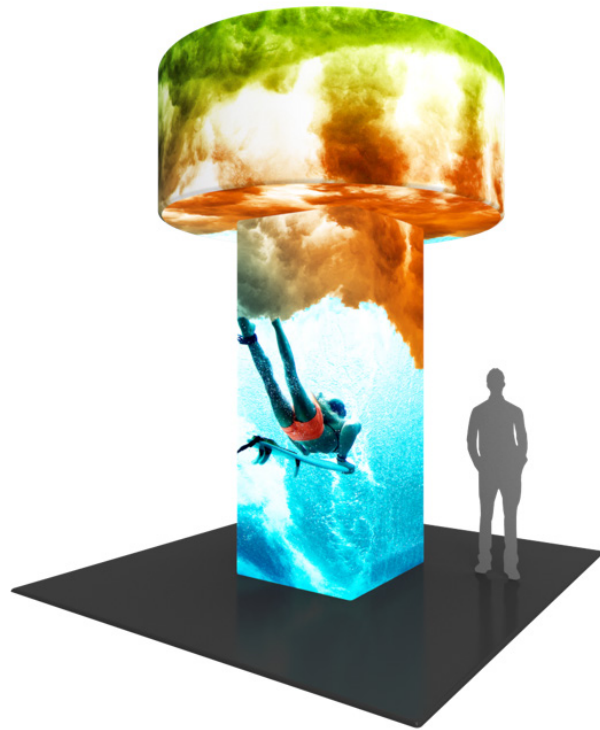

features and benefits:

- State-of-the-art 30mm aluminum tube frame with snap button assembly
- Easy to store and ship
- Impactful illuminated display
- Lights attach & stay taught on frame with bungee cords
- Optional hard packaging if desired: SCrate
- Includes: one ring frame, one platform frame, one tower frame, two dye-sublimated zipper pillowcase graphics, five 16-strip curtain lights, and two 20-strip curtain lights
- Lifetime hardware warranty against manufacturer defects

dimensions:

Hardware

Assembled unit:
119.5" w x 172" h x 119.5" d
3035mm(w) x 4369mm(h) x 3035mm(d)

Approximate weight (includes graphic):
106 lbs / 48 kg

Shipping

Shipping dimensions:
Hardware Box 1:
39" l x 16" h x 15" d
991mm(l) x 407mm(h) x 381mm(d)

Hardware Box 2:
52" l x 10" h x 18" d
1321mm(l) x 254mm(h) x 458mm(d)

Hardware Box 3:
48" l x 15" h x 18" d
1220mm(l) x 381mm(h) x 458mm(d)

Graphic Box 1:
24" l x 8" h x 14" d
610mm(l) x 204mm(h) x 356mm(d)

Approximate shipping weight:
Box 1: 48 lbs / 22 kg

Box 2: 49 lbs / 23 kg

Box 3: 37 lbs / 17 kg

Graphic

Refer to related graphic template for more information.

Visit:
www.exhibitors-handbook.com/graphic-templates

additional information:

Graphic material:
Dye-sublimation zipper pillowcase fabric (sold separately)

Minimum 2 person assembly recommended:



Assembly guidance & notes:

- Parts are all #’d for easy assembly; 2 screw drivers included
- Assembly sequence: 1) Ring 2) Tower 3) Platform 4) Lights 5) Graphics
- Recommend 8ft or 10ft ladder for assembly
- Approx. 5-6 hrs. assembly for 2 people

We are continually improving and modifying our product range and reserve the right to vary the specifications without prior notice. All dimensions and weights quoted are approximate and we accept no responsibility for variance. E&OE. See Graphic Templates for graphic bleed specifications.

Included In Your Kit

Tools, Components, & Connectors



x8



x8

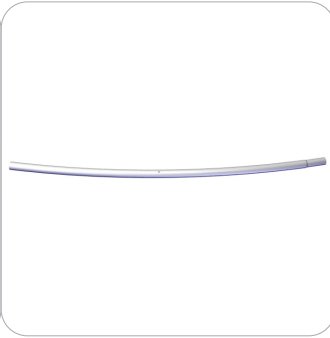

x8

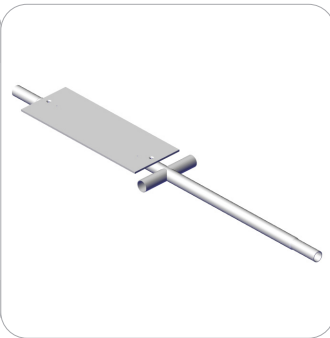

x1

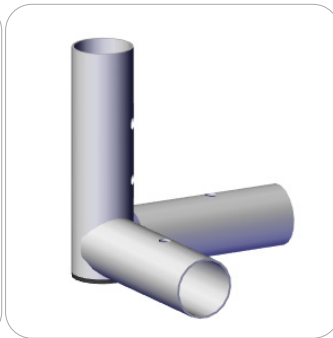

x4

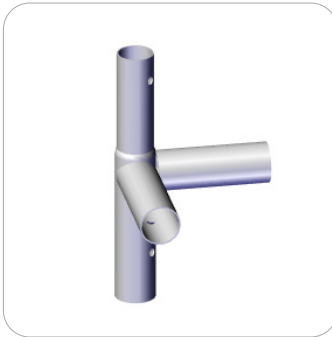

x4



x8

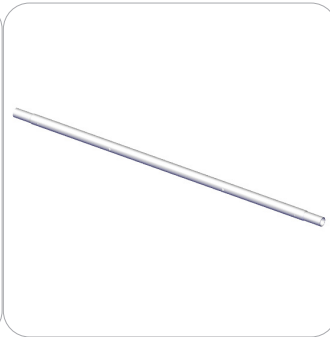

x8

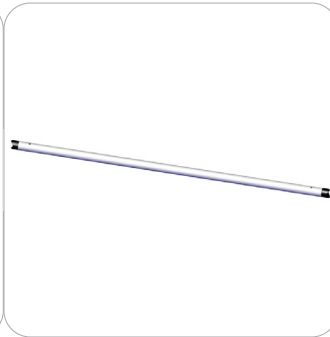

x2

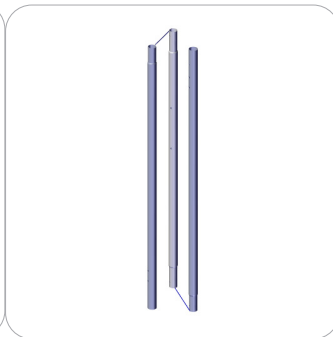

x4

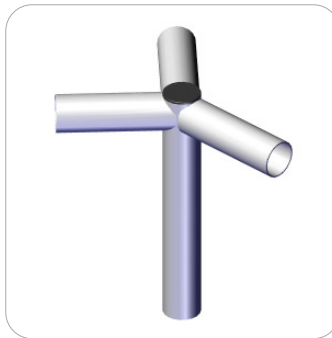

x4

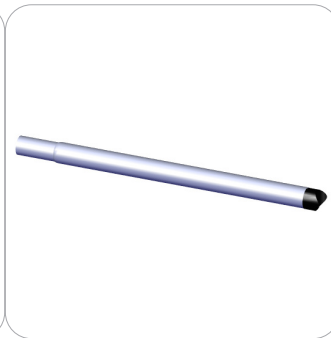

x4



x10

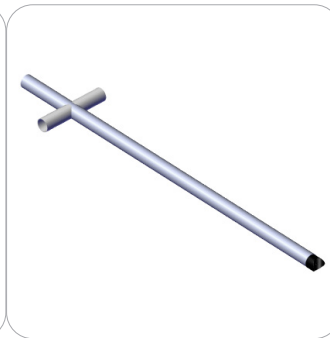

x4

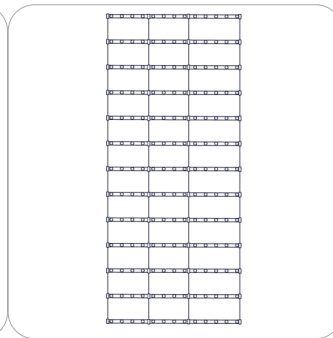

x4

Included In Your Kit

Tools, Components, & Connectors



x1



x2



x7



x1

Graphics

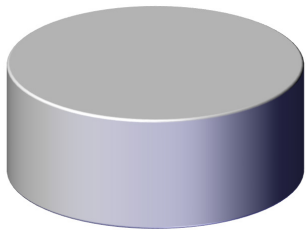

x1

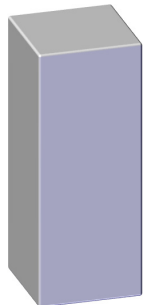

x1

Ring - Exploded View

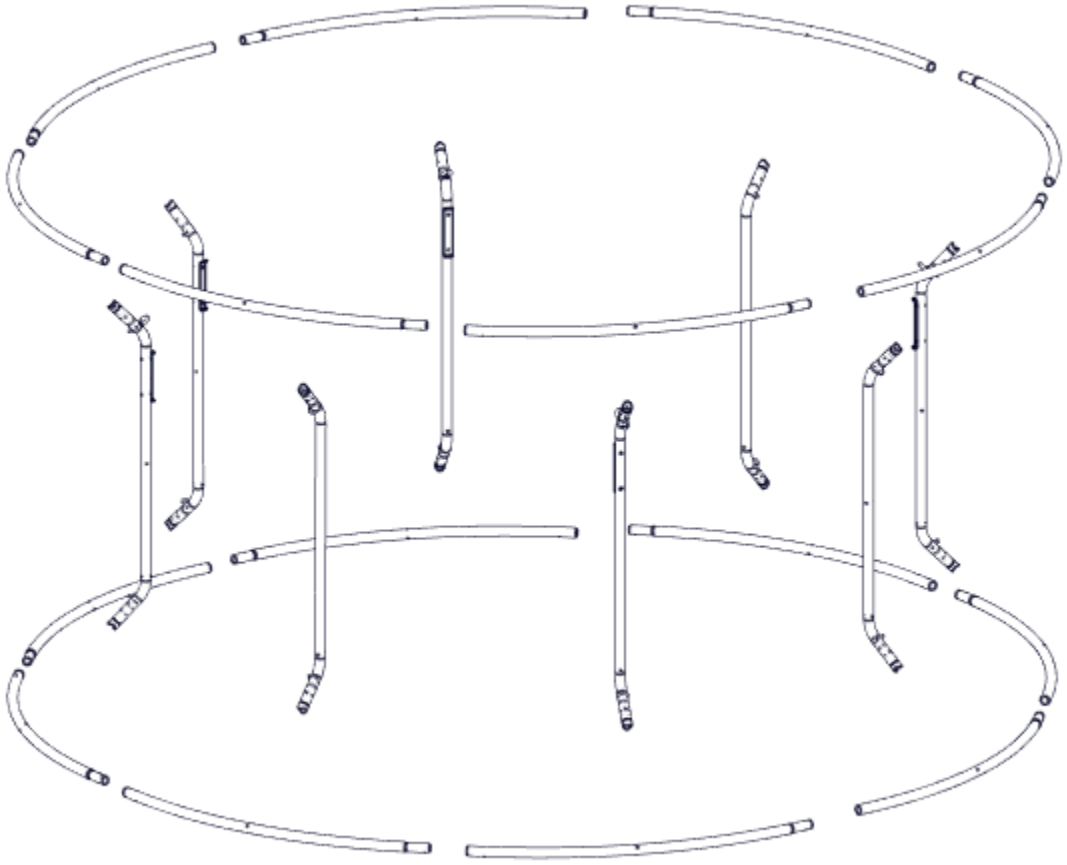

Platform - Exploded View

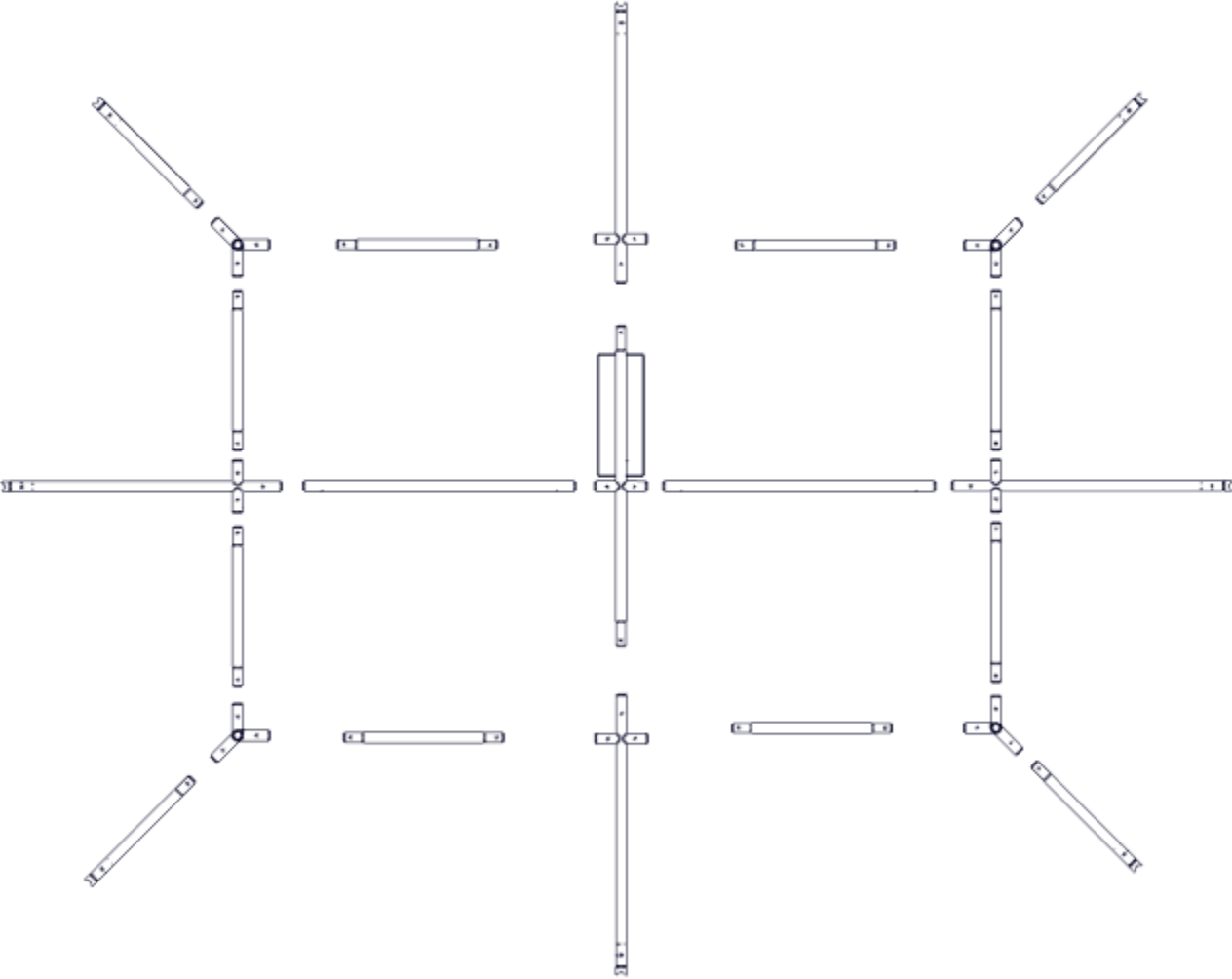

Tower - Exploded View

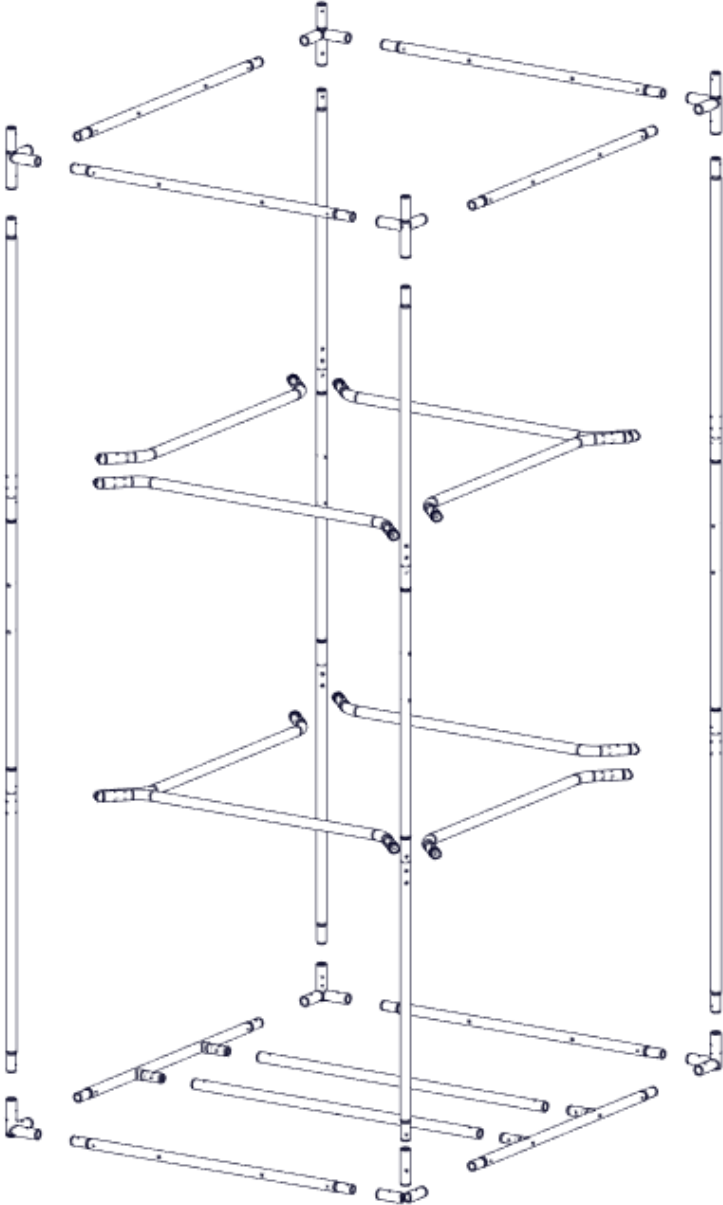

Ring - Labeling Diagram

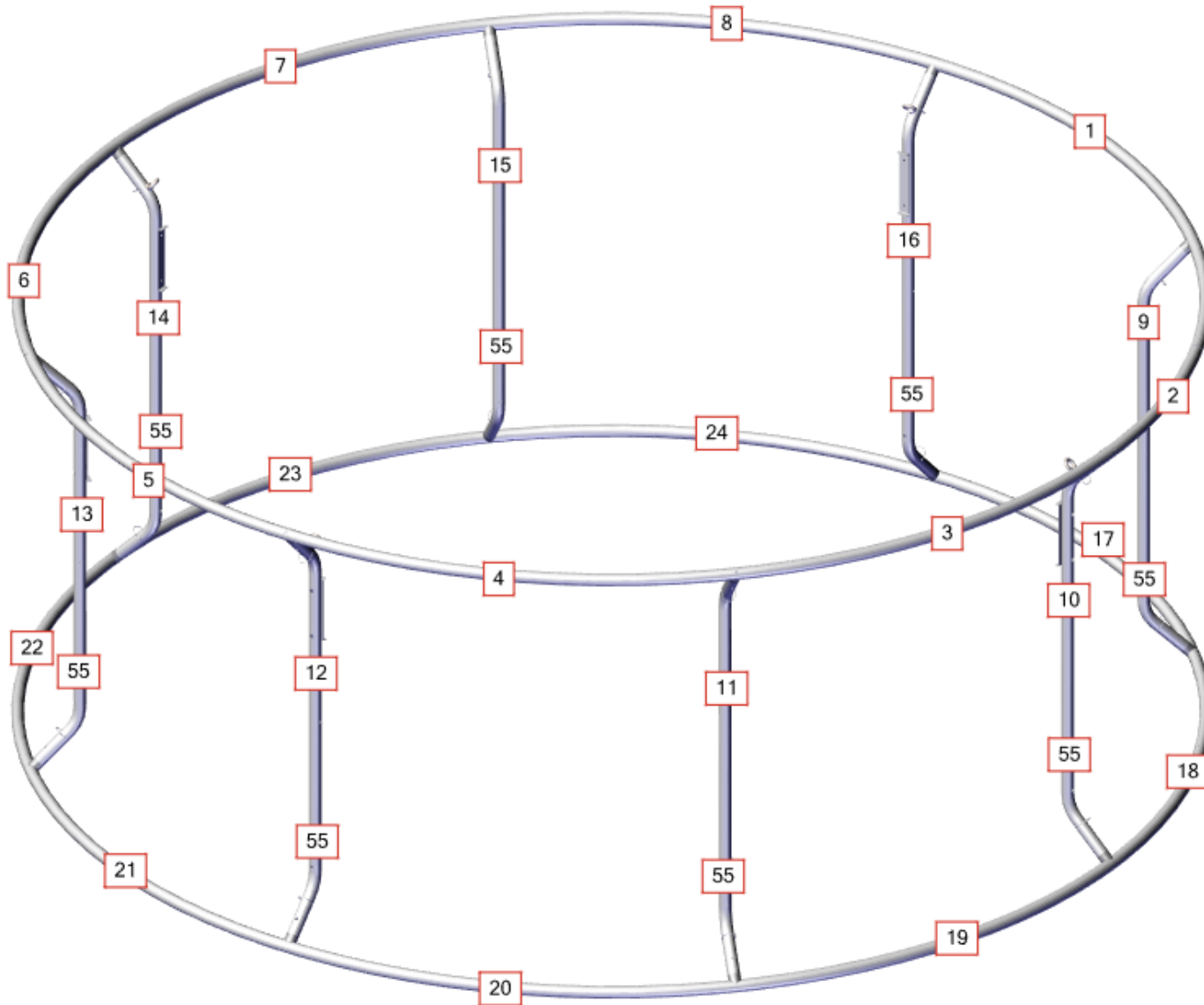

Platform - Labeling Diagram

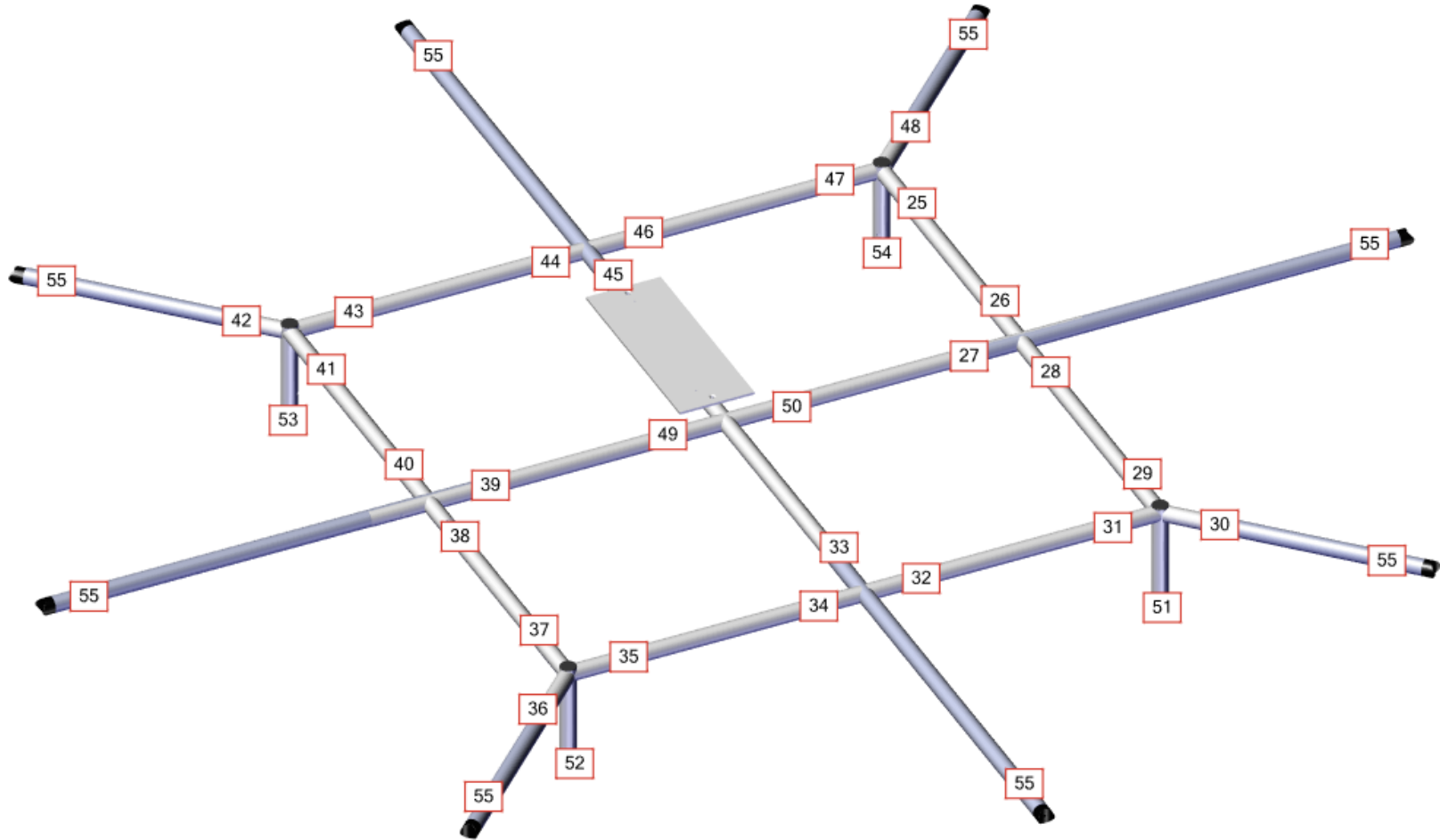

Tower - Labeling Diagram

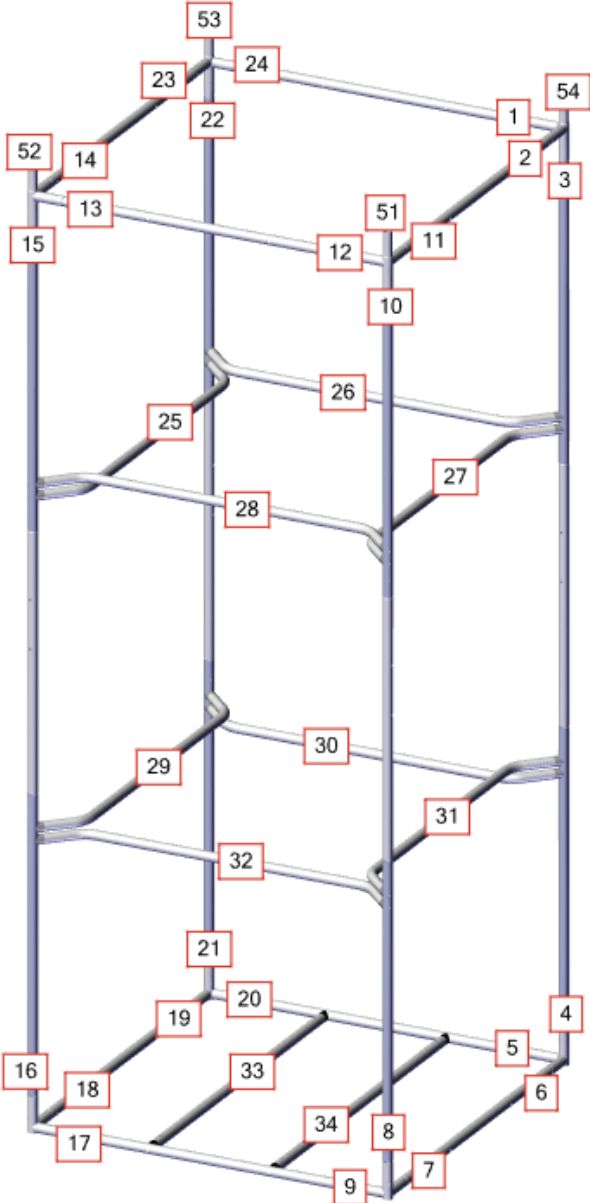

Lighting Diagram

Ring Structure

Curtain Light A



x4

Curtain Light B



x1

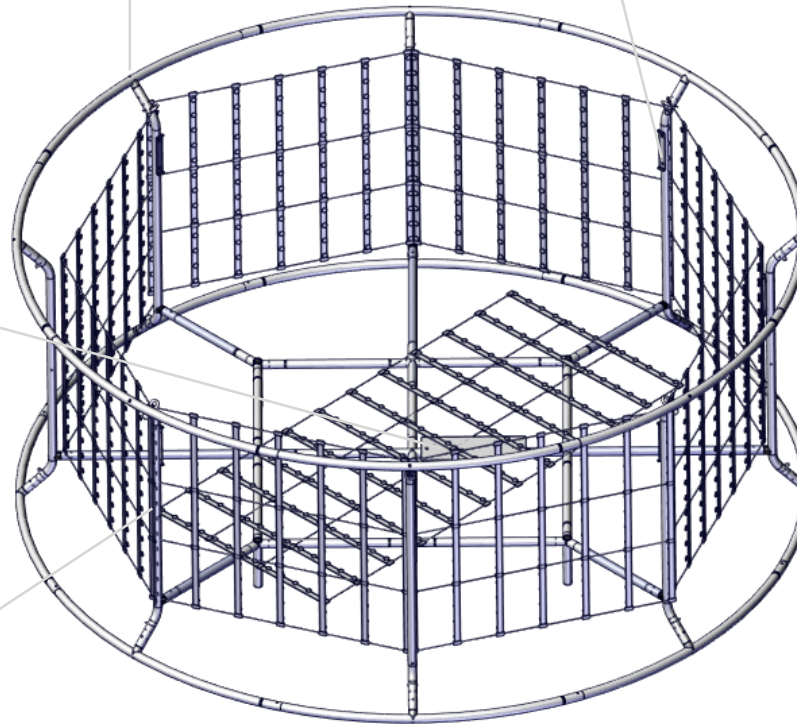
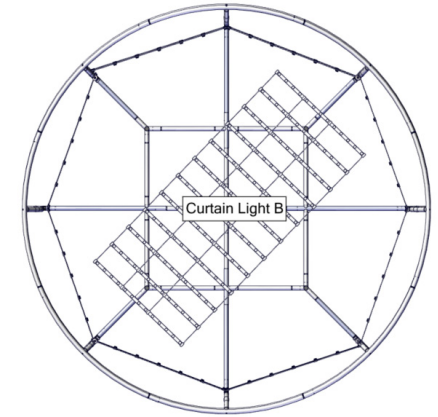

Five sets of curtain lights are needed for the ring structure frame. four sets of curtain light A attach along the perimeter of the ring structure frame, hooking onto wire loops located at each end of the spreaders. Curtain light B runs horizontally along the middle of the frame, facing upward, attaching to the same wire loops that curtain light A utilizes.

Gather the necessary power supplies for the ring structure. Attach the power supplies to small brackets, using the hook & loop solution, located on the spreaders. Then attach the five sets of curtain lights to the power supplies, with the five power cords connected to the power strip located in the center of the platform. Feed the power strip cord out of the bottom of the frame, which will then feed down through the tower.

Lighting Diagram

Tower Structure

Curtain Light C



x2

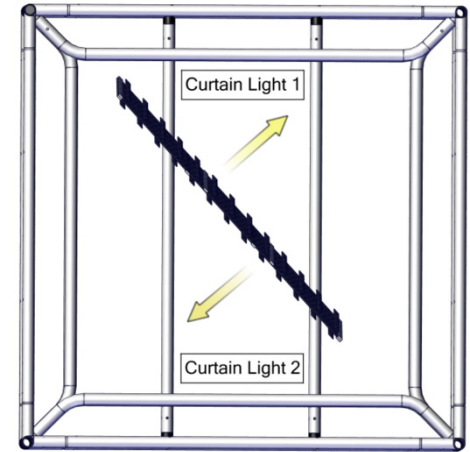
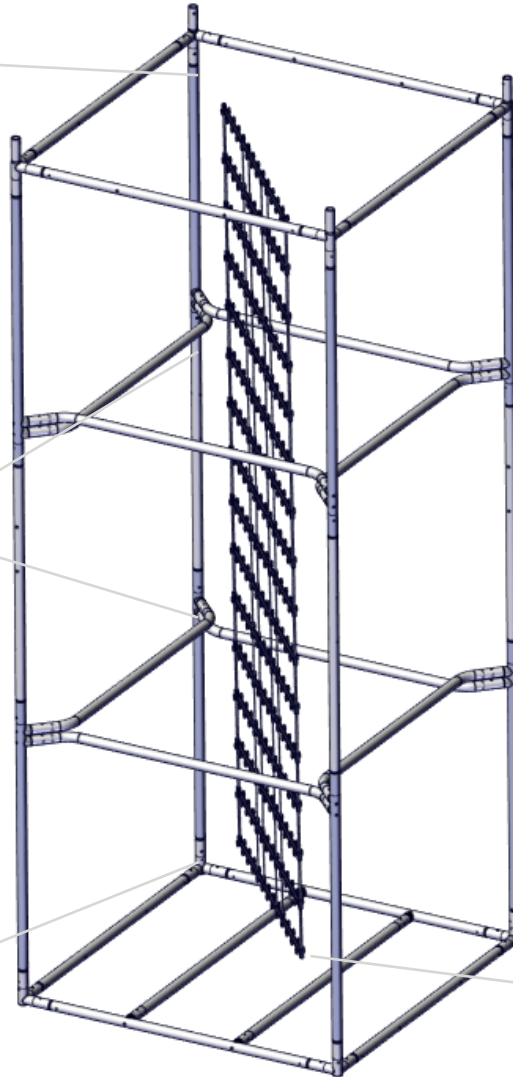

Two sets of curtain light C are needed for the tower frame. Both sets of curtain lights rest back-to-back, with one set of lights facing one direction and the other set facing the opposite direction. Both sets of lights utilize bungee cords with plastic hooks, which clip onto small rings located along the tower.

Gather the necessary power supplies for the tower. Attach the power supplies to both sets of curtain lights. Feed the power cords out of the bottom of the frame.

Assembly Diagram

A: Platform to Ring

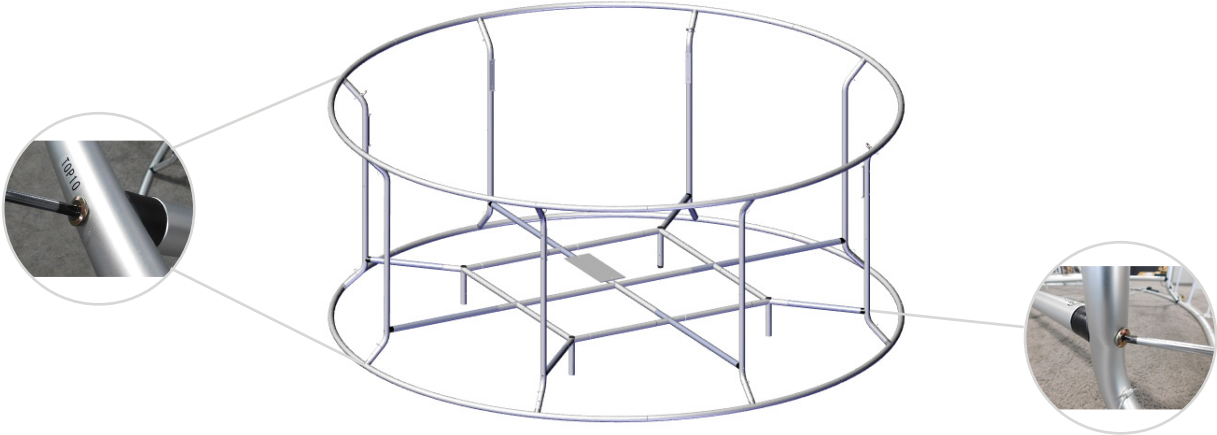

B: Ring to Tower

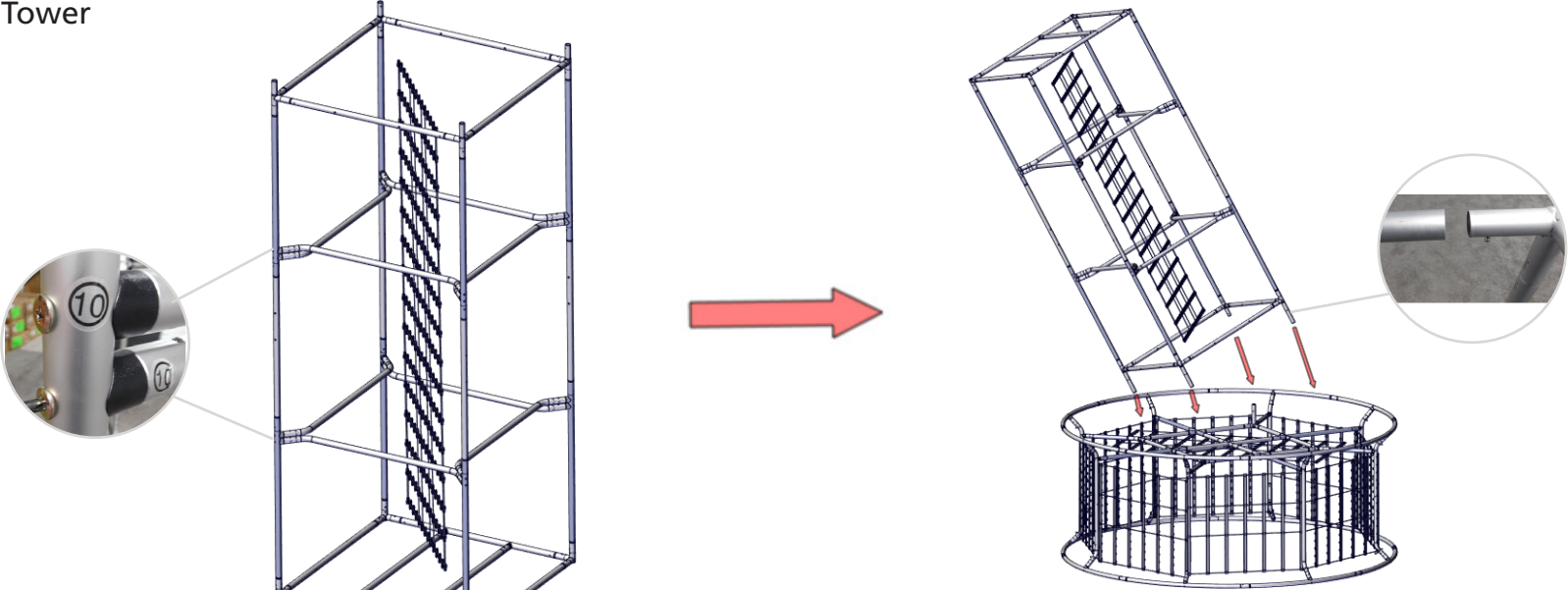

SHOWN WITHOUT GRAPHICS FOR ASSEMBLY DEMONSTRATION

Assembly Process

Step by Step

Step 1.

Gather the components necessary for assembling the ring structure. Assemble in the order the **Labeling Diagram** instructs.

Use the provided screwdriver to secure the spreaders onto the ring.

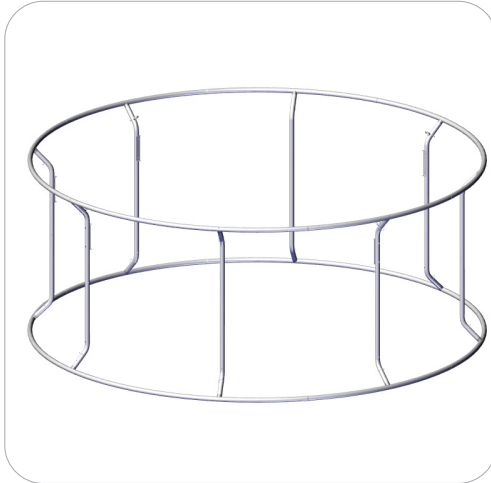

Step 2.

Gather the components necessary for assembling the ring platform. Assemble in the order the **Labeling Diagram** instructs.

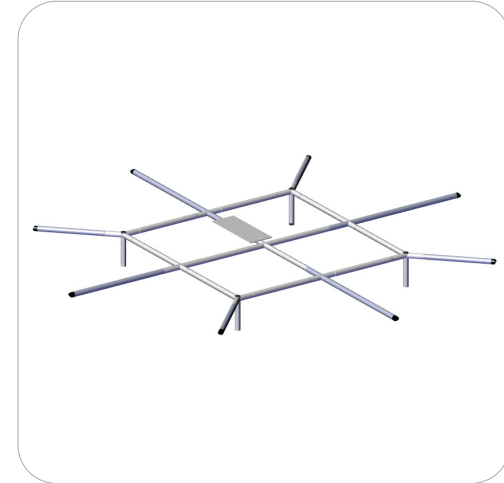

Step 3.

Gather both the assembled ring and assembled platform. Attach the platform onto the ring structure following the **Assembly Diagram**.

Use the provided screwdriver to secure the platform onto the ring structure.

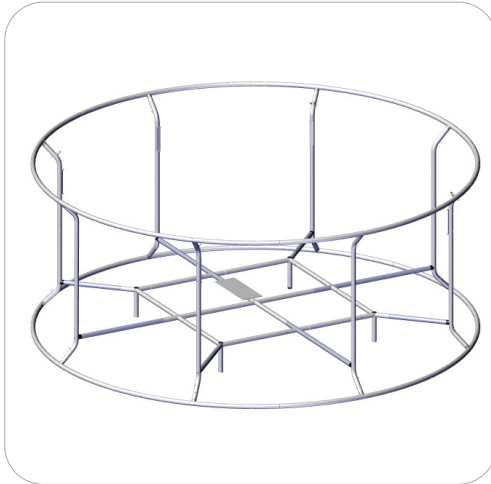

Step 4.

Gather the components necessary for assembling the tower. Assemble in the order the **Labeling Diagram** instructs.

Use the provided screwdriver to secure the spreaders onto the tower.

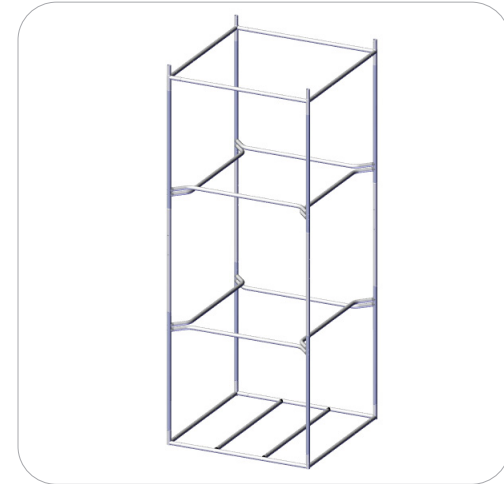

Assembly Process

Step by Step

Step 5.

Gather the necessary curtain lighting for the ring structure. Attach lighting to the ring structure following the **Lighting Diagram**.

Gather the necessary power supplies for the ring structure curtain lighting. Attach onto the ring structure following the Lighting Diagram.

Plug curtain lighting into the power supplies, then plug the power supplies into the power strip, which is located on the ring platform.

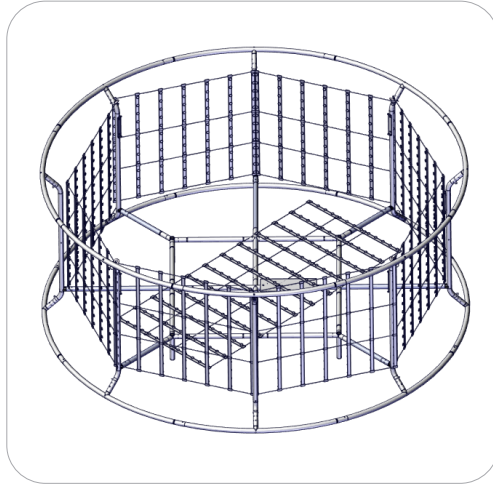

Step 6.

Gather the necessary curtain lighting for the tower. Attach lighting to the tower following the **Lighting Diagram**.

Gather the necessary power supplies for the tower. Attach onto the tower following the Lighting Diagram.

Plug curtain lighting into the power supplies.

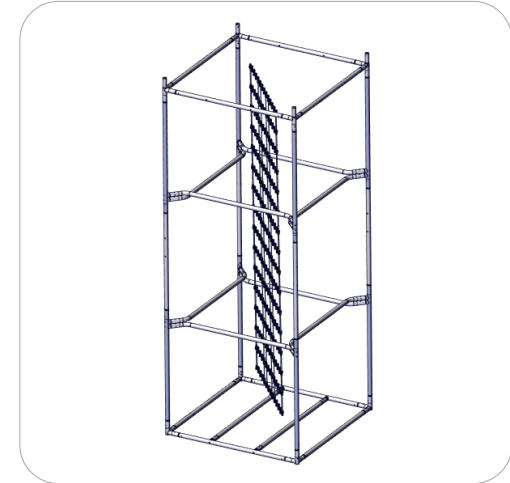

Step 7.

Locate your pillowcase graphic necessary for the ring structure. With the pillowcase unzipped, encase the ring structure by covering the frame top to bottom. Zipper at the top. Feed the power cord through opening in the bottom of the graphic.

Keep in mind that when attaching the ring structure graphic, the platform should already be attached to the ring.

(A clean surface is recommended while attaching graphics)

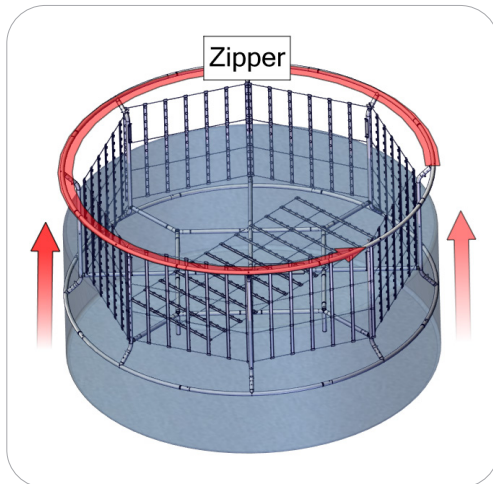

Step 8.

Locate your pillowcase graphic necessary for the tower. With the pillowcase unzipped, encase the tower by covering the frame top to bottom. Zipper along the bottom, as well as the sides of the frame.

Allow the corner connection points at the top of the tower, which will connect to the assembled ring structure, to feed through the cutouts in the graphic.

(A clean surface is recommended while attaching graphics)

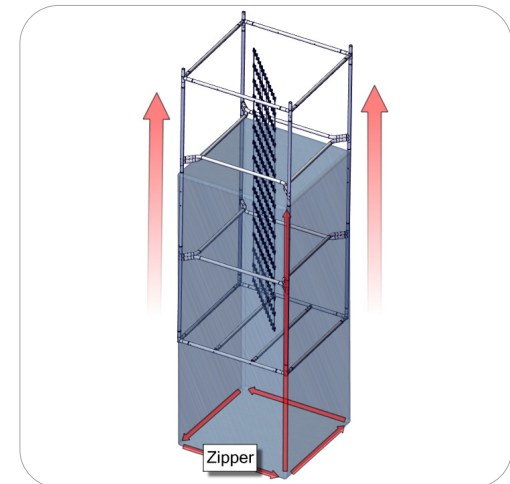

Assembly Process

Step by Step

Step 9.

With your graphics now attached to both the ring structure and tower, assemble the ring structure onto the tower following the **Assembly Diagram**.

Make sure to attach the tower to the ring structure with the ring structure upside down, and the connectors facing up.

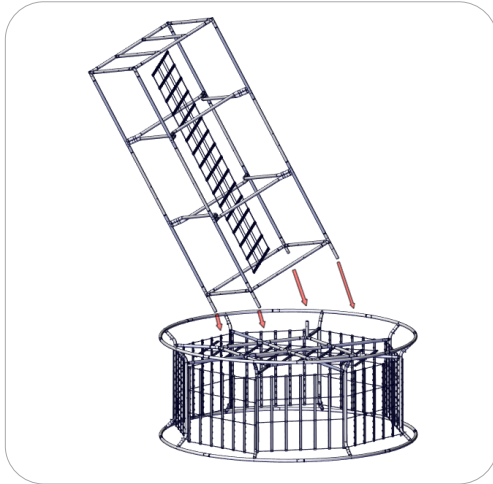

SHOWN WITHOUT GRAPHICS FOR ASSEMBLY DEMONSTRATION

Step 10.

With the ring structure now attached to the tower, slowly flip the assembled unit rightside up.

Make sure that the power cords from the ring structure are fed through the tower, and out the bottom of the unit.

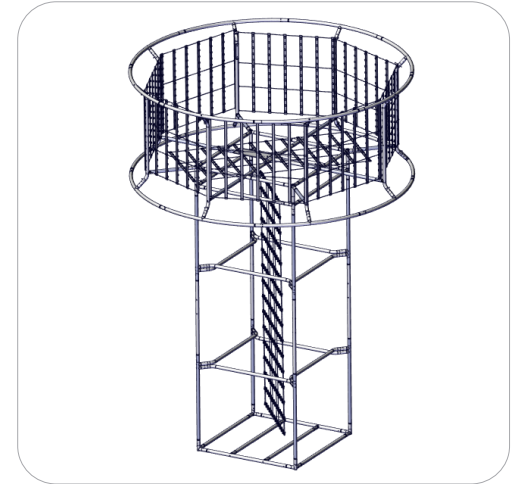

SHOWN WITHOUT GRAPHICS FOR ASSEMBLY DEMONSTRATION

Step 11.

Once the unit is assembled, ensure that graphic fits properly and lighting is efficient.

Setup Complete.

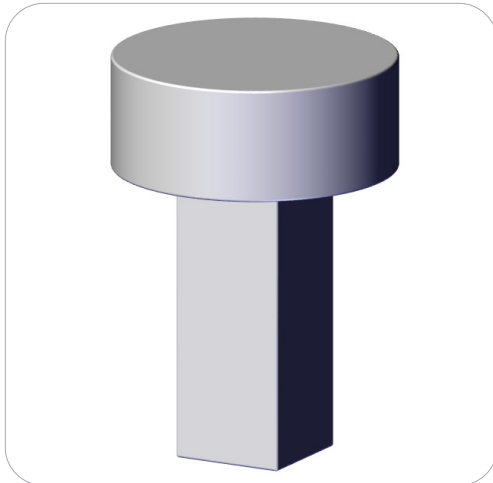

Connection Methods

Connection Method 1: SNAP BUTTONS

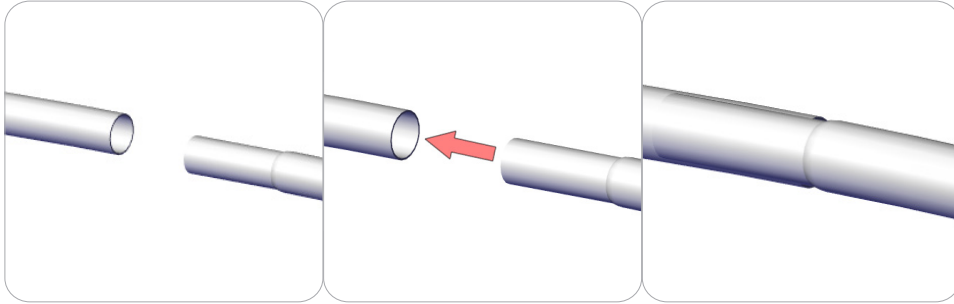

For snap button connections, locate the snap button on the connector or swage tube. Locate the hole on the corresponding tube. Press the snap button with your thumb and slide the tube and connector together so that the snap button snaps fully into the lock hole. To disassemble, press the snap button and pull apart.

Connection Method 2: SPREADER TO RING

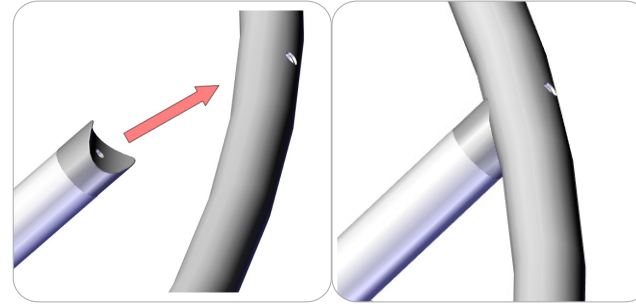

Join the ring structure by attaching the included spreaders. Locate the spreader inserts along the corresponding tube. Secure the spreader onto the ring structure using the included screwdriver. To disassemble, unscrew the spreader and detach from the corresponding tube.

Connection Method 3: PLATFORM TO RING

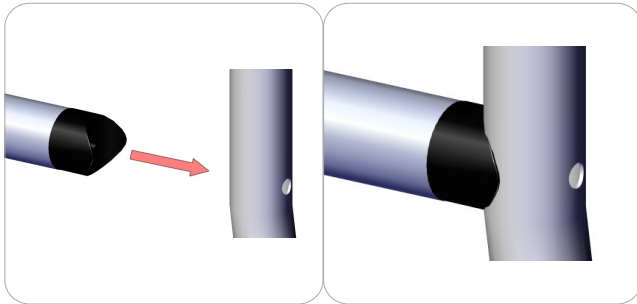

Join the ring structure by attaching the included spreaders. Locate the spreader inserts along the corresponding tube. Secure the spreader onto the ring structure using the included screwdriver. To disassemble, unscrew the spreader and detach from the corresponding tube.

Connection Method 4: SNAP BUTTONS

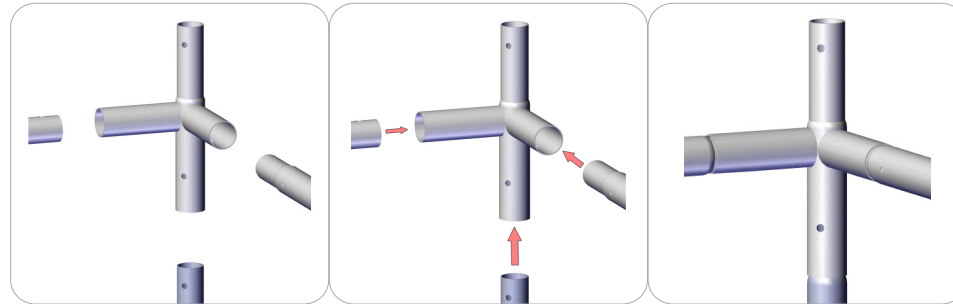

For snap button connections, locate the snap button on the connector or swage tube. Locate the hole on the corresponding tube. Press the snap button with your thumb and slide the tube and connector together so that the snap button snaps fully into the lock hole. To disassemble, press the snap button and pull apart.

Connection Methods

Connection Method 5: SNAP BUTTONS

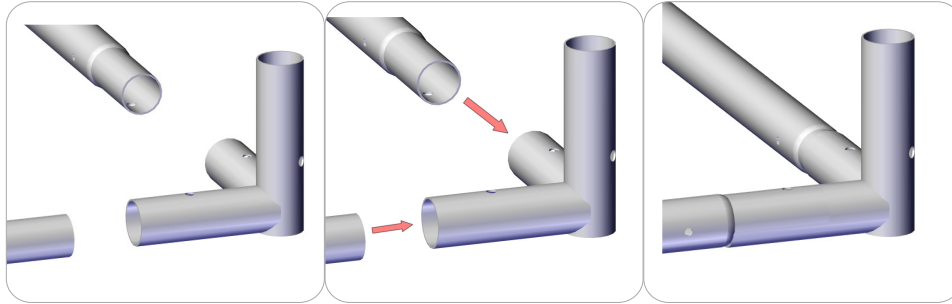

For snap button connections, locate the snap button on the connector or swage tube. Locate the hole on the corresponding tube. Press the snap button with your thumb and slide the tube and connector together so that the snap button snaps fully into the lock hole. To disassemble, press the snap button and pull apart.

Connection Method 6: SPREADER TO TOWER

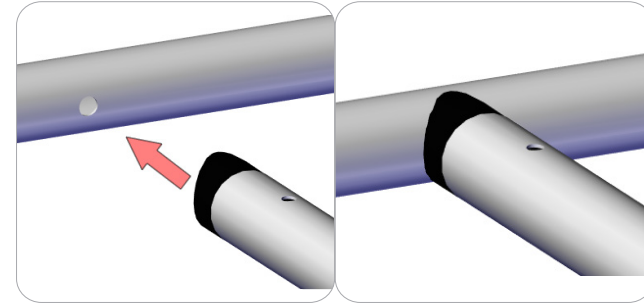

Join the tower structure by attaching the included spreaders. Locate the spreader inserts along the corresponding tube. Secure the spreader onto the ring structure using the included screwdriver. To disassemble, unscrew the spreader and detach from the corresponding tube.

Connection Method 7: SPREADER TO TOWER

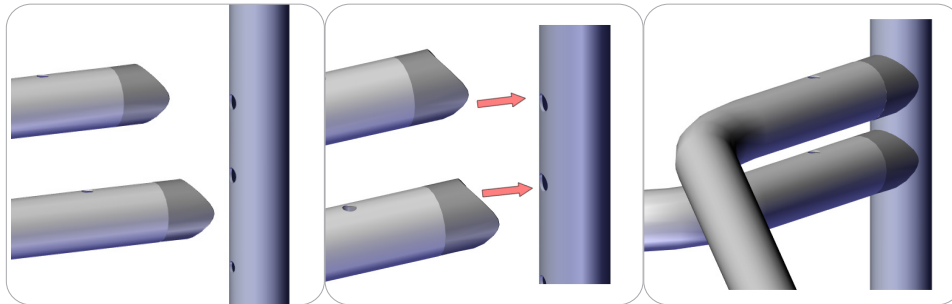

Join the tower structure by attaching the included spreaders. Locate the spreader inserts along the corresponding tube. Secure the spreader onto the ring structure using the included screwdriver. To disassemble, unscrew the spreader and detach from the corresponding tube.

Connection Method 7: RING TO TOWER

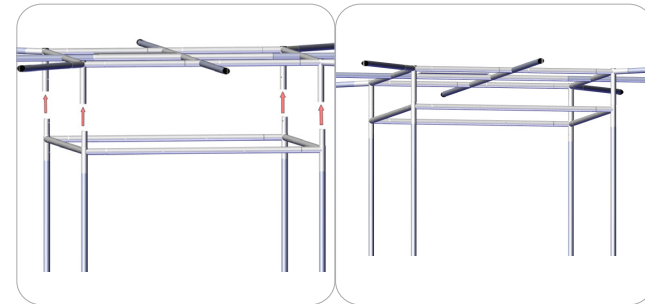

Join the platform to the tower structure. Keep in mind that the ring structure should already be attached to the platform when being attached to the tower structure. Locate the snap button on each of the connectors or swage tubes illustrated above. Press the snap button with your thumb and slide the tube and connector together so that the snap button snaps fully into the lock hole. To disassemble, press the snap button and pull apart.